

SPITI  
HERITAGE HOMES



*W*elcome to a world where your home  
is more than just a residence - A statement  
of luxury and sophistication.



Presenting  
**Independent Plots**



**At Sector 1, Pataudi**

*S*piti Heritage Homes, a plotted development Project in Pataudi, offers an exceptional opportunity for residents and investors alike. Nestled Approximately in 19Acres in strategic location, Spiti Heritage Homes features well-planned plots that cater to various preferences and needs, prioritizing high-quality green living providing a harmonious blend of convenience, comfort, and connectivity.





*"Nature is the art of God"*

*\*Reference Image*

# PROJECT HIGHLIGHTS



Gated Community with 24x7 Security

---



Access Controlled Entry & Exit

---



Attractive Plot Sizes

---



Moderately Dense with Clean Air & Serenity

---



Multiple Green Parks within the Project

---





*"Living close to nature enriches the soul and nourishes the spirit."*



\*Reference Image

# SITE PLAN

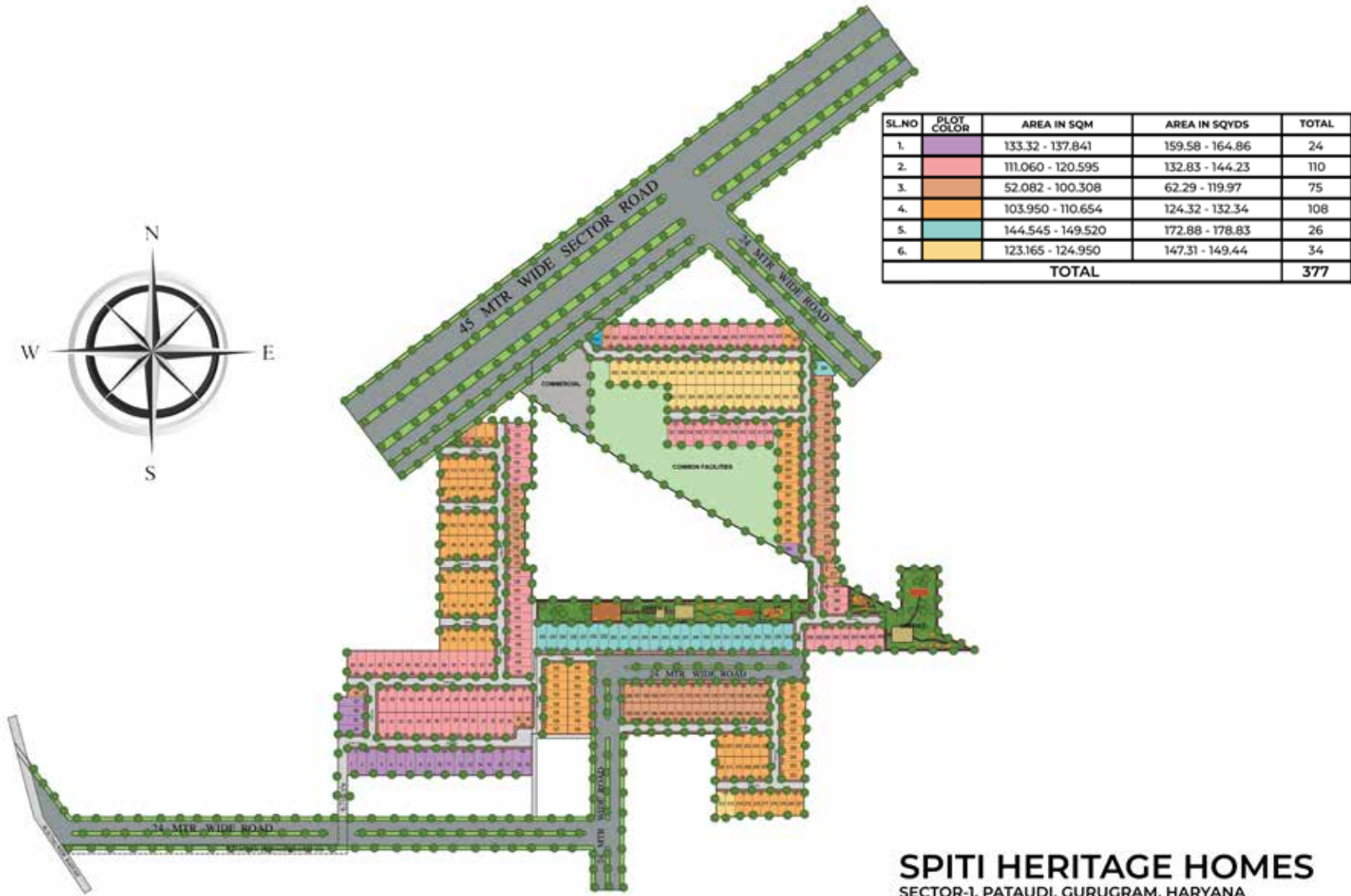

**SPITI HERITAGE HOMES**  
SECTOR-1, PATAUDI, GURUGRAM, HARYANA



*"Once you truly love nature, you will find beauty everywhere"*

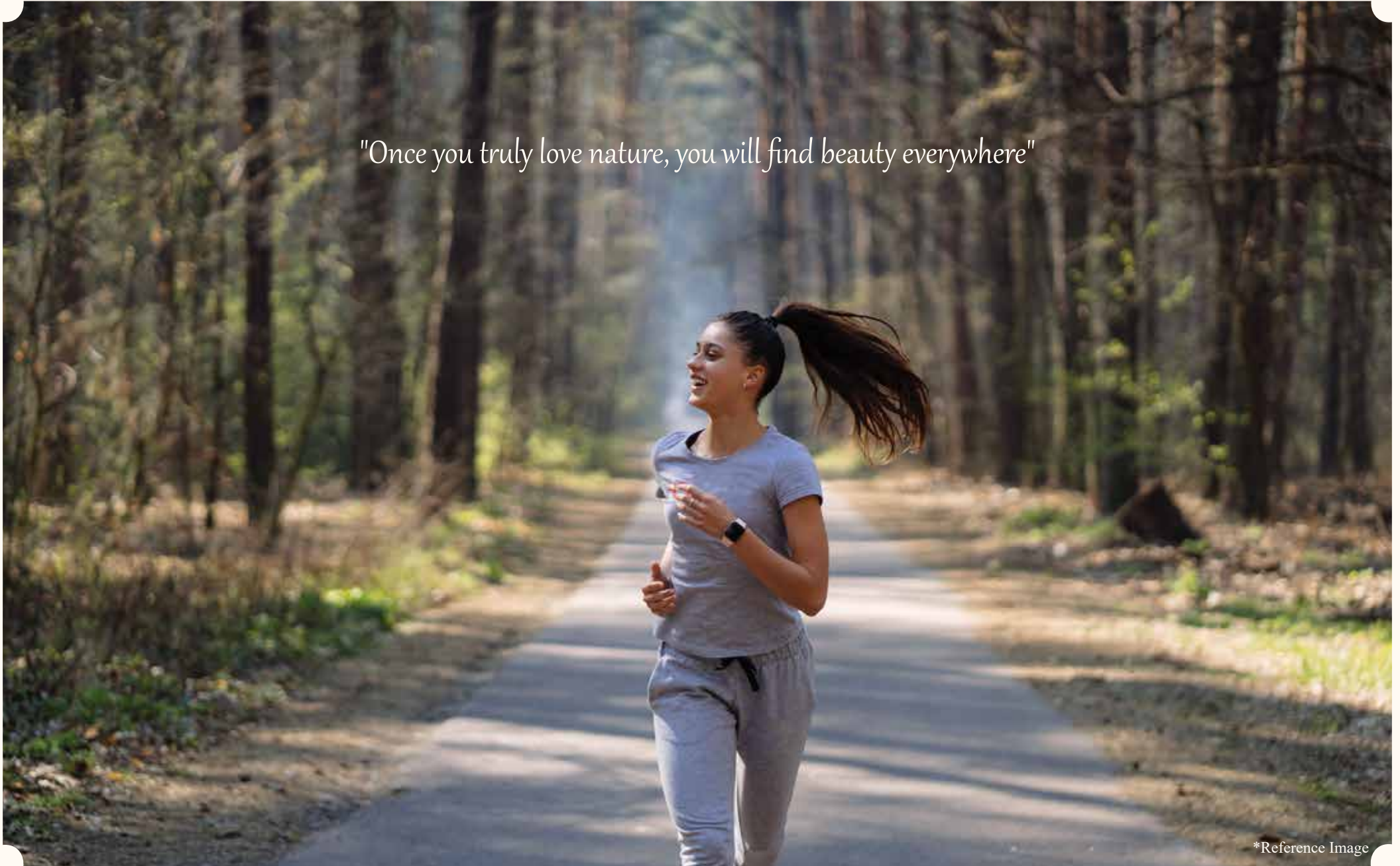

\*Reference Image



# PROJECT AMENITIES



\*Reference Image



Well Lit Internal Roads

---



Kids Play Area

---



Seamless Connectivity to Major Roads

---



Surrounded by Urban Conveniences

---



Green & Landscape Area

---



Commercial Center within the Premises

---





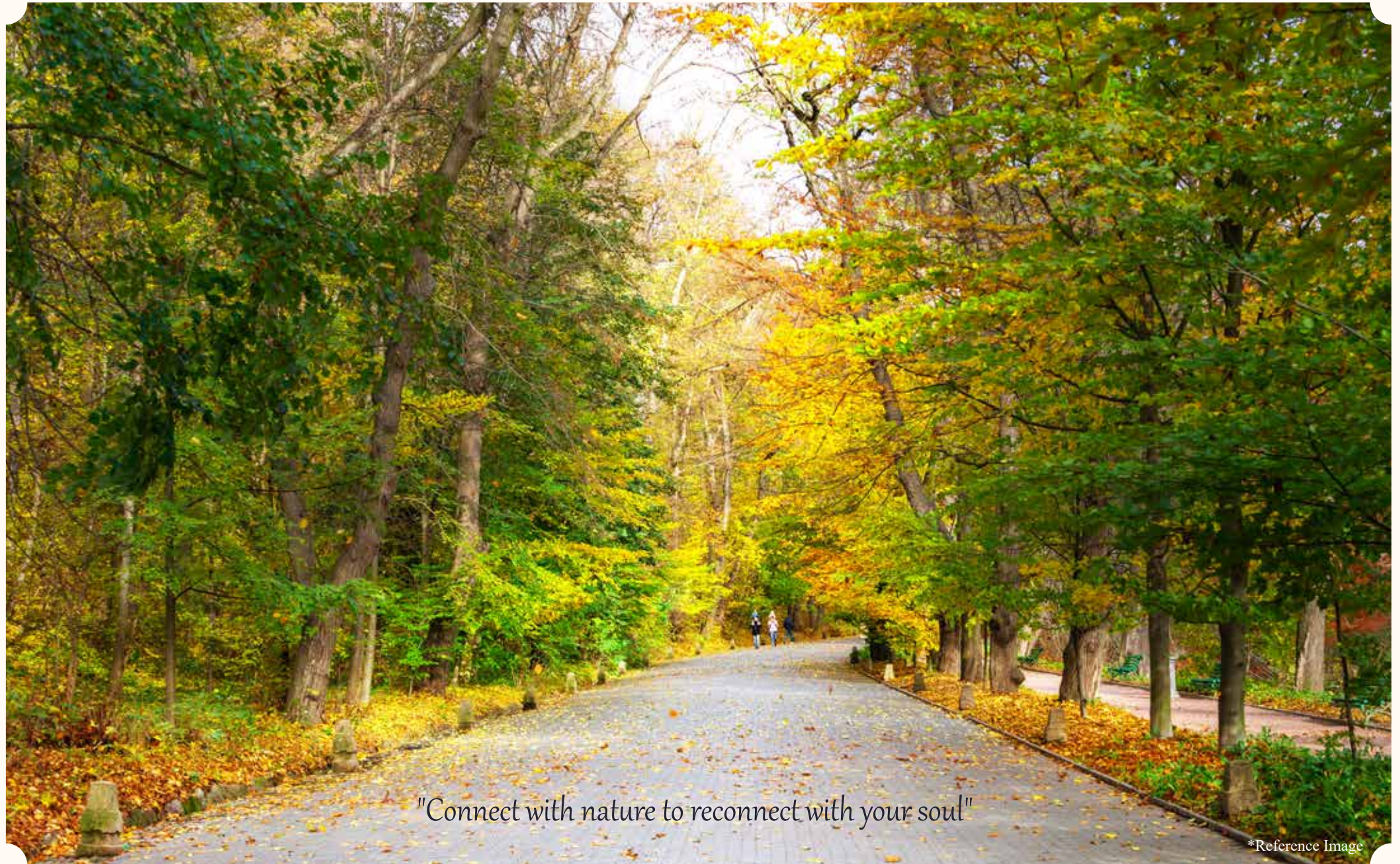

*"Connect with nature to reconnect with your soul"*

*\*Reference Image*



# LOCATION ADVANTAGES



- ✦ Pataudi Palace - 3 Min

---

- ✦ Pataudi Bus Stand - 4 Min

---

- ✦ Gurugram Pataudi Rewari H-Way (NH352 W) - 5 Min

---

- ✦ Pataudi Railway Station - 10 Min

---

- ✦ Gurugram - 20 Min

---

- ✦ Farukhnagar - 25 Min

---

- ✦ NH 8 - 30 Min

---

- ✦ KMP Expressway - 30 Min

---

- ✦ Neemrana Fort - 60 Min

---

- ✦ Rampura Chowk - 35 Min

---





A family of four is sitting on a grassy bank by a lake, enjoying a picnic. They are seen from behind, sitting on a blanket with baskets of food. A large tree with dense green foliage is in the foreground, with sunlight filtering through the leaves, creating a warm, golden glow. The scene is peaceful and idyllic.

*“The earth has its music for those who listen”*

*\*Reference Image*



# LOCATION MAP



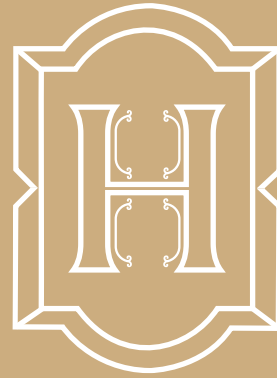

SPiTi  
HERITAGE HOMES

 **86044-06044**

Site Address: Spiti Heritage Homes, Sector 1, Pataudi, Haryana 122503  
Corporate Office: Spiti Developers, 4<sup>th</sup> Floor, Plot No. 96, Sector 44, Gurgaon, Haryana 122003

 [sales@spitidevelopers.com](mailto:sales@spitidevelopers.com)

 [www.spitidevelopers.com](http://www.spitidevelopers.com)

