

011-40611111
marketing@raheja.com
www.raheja.com

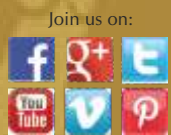

Shiva; Hara; Mrida; Rudra; Pushkara; Pushpalochana; Arthigamya; Sadachara; Sharva; Shambhu; Maheshvara; Chandrapida; Chandramouli; Vishva; Vishvamareshvara; Vedantasara-sandoha; Kapali; Nilalohita; Dhyanadhara; Aparicchedyia; Gouribharta; Ganeshvara; Ashtamurti; Vishvamurti; Trivargasvargasadhana; Jnanagamya; Dridaprajna; Devadeva; Trilochana; Vamadeva; Madadeva; Patu; Parivrida; Drida; Vishvarupa; Virupaksha; Vagisha; Shuchisattama; Sarvaprarnapasamvadi; Vrishanka; Vrishavahana; Isha; Pinaki; Khatvanga; Chitravasha; Chirantana; Tamohara; Mahayogi; Gopta; Brahma; Dhurjati; Kalakala; Krutivasah; Subhaga; Pranavatmaka; Unnadhra; Purusha; Jushya; Durvasa; Purashasana; Divyayudha; Skandaguru; Parameshthi; Paratpara; Anadimadhyanidhana; Girisha; Girijadhava; Kuberabandhu; Shrikanatha; Lokavarnottama; Mridu; Samadhivedya; Kodandi; Nilakantha; Parashvadi; Vishalaksha; Mrigavyadha; Suresha; Suryatapana; Dharmadhama. Kshamakshetra; Bhagavana; Bhaganetrabhida; Ugra; Pashupati; Tarkshya; Priyabhakta; Parantapa; Data; Dayakara; Daksha; Karmandi; Kamashasana; Shmashananilaya; Suksha; Shmashanastha; Maheshvara; Lokakarta; Mrigapati; Mahakarta; Mahoushadhi; Uttara; Gopati; Gopta; Jnanagamya; Puratana; Niti; Suniti; Suddhatma; Soma; Somarata; Sukhi; Sompapa; Amritapa; Soumya; Mahatejah; Mahadyuti; Tejomaya; Amritamaya; Annamaya; Suhapati; Ajatashatru; Aloka; Sambhavya; Havyvahana; Lokakara; Vedakara; Sutrakara; Sanatana; Maharshi; Kapilacharya; Vishvadiphi; Vilochana; Pinakapani; Bhudeva; Svastida; Svastikrita; Sudhi; Dhatridhama; Dhamakara; Sarvaga; Sarvagochara; Brahmasrika; Vishvasrika; Sarga; Karnikara; Priya; Kavi; Shakha; Vishakha; Goshakha; Shiya; Bhishaka; Anuttama; Gangaplavodaka; Bhaya; Pushkala; Sthapati; Sthira; Vijijatma; Vishayatma; Bhutavahana; Sarathi; Sagana; Ganakaya; Sukirti; Chinnasamshaya; Kamadeva; Kamapala; Bhasmoddhulita-vigraha; Bhasmapriya; Bhasmashyai; Kami; Kanta; Kritagama; Samavarta; Nivritatma; Dharmapunja; Sadashiva; Akalmasha; Chaturvahu; Durvasa; Durasada; Durlabha; Durgama; Durga; Sarvayudhavisharada; Adhyatmayoganilaya; Sutanku; Tantuvardhana; Shubhanga; Lokasaranga; Jagadisha; Janardana; Bhasmashuddhikara; Meru; Ojasvi; Shuddhavigraha; Asadhya; Sadhusadhya; Bhriyamarikatrapadhrika; Hiranyareta; Pourana; Ripujvahara; Bala; Mahahrata; Mahagarta; Vyal; Siddhavrindaravandita; Vyaghracharmambara; Mahabhuta; Mahanidhi; Amritasha; Amritavapu; Panchajanya; Prabhanjana; Panchavimshatitavastha; Parijata; Para-vara; Sulabha; Suvrata; Shura; Brahmavedanidhi; Nidhi; Namashramaguru; Varni; Shatrujita; Shatrutapana; Ashrama; Kshapana; Kshama; Jnanavana; Achaleshvara;Pramanabhuta; Durjneya; Suparna; Vayuvahana; Dhanurdhara; Dhanurveda; Gunarashi; Gunakara; Satyasatyapara; Dina; Dharmaga; Ananda; Dharmasadhana; Anantadrishti; Danda; Damayita; Dama; Abhivadya; Mahamaya; Vishvakarma; Visharada; Vitaraga; Vinitatma; TapaSvi; Bhutabhavana; Unmattavasha; Pracchanna; Jitakama; Ajitapriya; Kalyanaprakriti; Kalpa; Sarvalokaprajapati; Tarasvi; Tavaka; Dhimana; Pradhanaprabhu; Ayyaya; Lokapala; Antarhitatma; Kalpadi; Kamalekshana; Vedashastrarthatattvajna; Aniyama; Niyatashraya; Chandra; Surya; Shani; Ketu; Varanga; Vidrumacchavi; Bhaktivashya; Anagha; Parabrahm-amrigavanarpana; Adri; Adryalaya; Kanta; Paramatma; Jagadguru; Sarvakarmalaya; Tusha; Mangalya; Mangalavrita; Mahatapa; Dirghatapa; Sthavishtha; Sthavira; Dhruva; Aha; Samvatsara; Vyapti; Pramana; Parmatapa; Samvatsarakara; Mantra-pratyaya; Sarvadarshana; Aja; Sarveshvara; Siddha; Mahareta; Mahabala; Yogi; Yogya; Siddhi; Mahateja; Sarvadi; Agraha; Vasu; Vasumana; Satya; Sarvapaphara; Sukirti; Shobhana; Shrimana; Avanmanasagochara; Amritashashvata; Shanta; Vanahasta; Pratapavana; Kamandalundhara; Dhanvi; Vedanga; Vedavita; Muni; Bhrajishnu; Bhojana; Bhokta; Lokanantha; Duradhara; Atindriya; Mahamaya; Sarvavasa; Chatuspatha; Kalayogi; Mahanada; Mahotsaha; Mahabala; Mahabuddhi; Mahavirya; Bhutachari; Purandara; Nishachara; Pretachari; Mahashakti; Mahadyuti; Ahirdeshyavapu; Shrimana; Sarvacharyamapogati; Vahushruta; Niyatatma; Dhruva; Adhruva; Sarvashaska; Ojastejodyutidara; Nartaka; Nrityapriya; Nrityanitya; Prakashatma; Prakashaka; Spashtakshara; Budha; Mantra; Samana; Sarasamplava; Yugadikrida; Yugavarta; Gambhira; Vrishavahana; Ishta; Vishishta; Shishteshta; Shalabha; Sharabha; Dhanu; Tirtharupa; Tirthanama; Tirthadrishta; Stuta; Arthada; Apamnidhi; Adhishtana; Vijaya; Jayakalavita; Pratishtita; Pramanajna; Hiranyakavacha; Hari; Vimochana; Suragana; Vidyeshha; Vindusamshraya; Balarupa; Vikarta; Balonmatta; Gahana; Guha; Karana; Karta; Sarvabandhavimochana; Vyavasaya; Vyavasthana; Sthanada; Jagadadija; Guruda; Lalita; Abheda; Bhavatmatmasamsthita; Vireshvara; Virabhadra; Virasनाविधि; Virata; Virachudamani; Vetta; Tivrananda; Nadidhara; Ajnadhara; Tridhuli; Shipivishtha; Shivalaya; Balakhilya; Mahachapa; Tigmamshu; Badhira; Khaga; Adhirma; Susharana; Subrahmanya; Sudhapati; Maghavana; Koushika; Gomana; Virama; Sarvasadhana; Lalataksa; Vishvadeha; Sara; Samsarachakrabhrita; Amoghadanda; Madhyastha; Hiranya; Brahmavarchasi; Paramartha; Para; Mayi; Shambara; Vyaghralochana; Ruchi; Virinchi; Svarbandhu; Vachaspati; Aharpati; Ravi; Virochana; Skanda; Shasta; Vaivasvata; Yama; Yukti; Unnatakirti; Sanuraga; Paranjaya; Kailashadhupati; Kanta; Savita; Ravilochana; Vidvattama; Vitabhaya; Vishvabharta; Anivarita; Nitya; Niyatakalyana; Punyashrvanakitana; Durashrava; Vishvasaha; Dhyeya; Duhsvapnanashana; Uttarana; Dushkritiha; Vijnya; Dushaha; Bhava; Anadi ; Bhurbhuvaksha; Kiriti; Ruchirangada; Janana; Jananmadi; Pritimana; Nitimana; Dhava; Vasishtha; Kashyapa; Bhanu; Bhima; Bhimaparakrama; Pranava; Satpachachara; Mahakasha; Mahaghana; Janmadhipa; Mahadeva; Sakalagamaparaga; Tattva; Tattavit; Ekatma; Vibhishana; Bhadrakali; Brahmacharya; Nitya; Nrityujaratiga; Panchayajnasamutpatti; Vishvesha; Vimalodaya; Atmayoni; Anadyanta; Vatsala; Bhaktalokadhrika; Gayatrivalabha; Pramshu; Vishvasava; Prabhakara; Shishu; Giriraha; Samrata; Sushena; Surashatruha; Amogha; Arishtanemi; Kumuda; Vigatajvara; Vivasvini; Ananta; Anant; Atmajyoti; Pingala; Kapilashmashru; Bhalanetra; Trayitanu; Jnanaskandamahani; Vishvotipatti; Upaplava; Bhaga; Vivasvana; Aditya; Yogapara; Divaspati; Kalyanagunanama; Papaha; Punyadarshana; Udarakirti; Udyogi; Sadyogi; Sadasanmaya; Nakshatramali; Nakesha; Svadhishthanapadashraya; Pavitra; Paphari; Manipura; Nabhogati; Hrit; Pundarikasina; Shatru; Shranta; Vrishakapi; Ushna; Grihapati; Krishna; Paramartha; Anarthanashana; Adharmashatru; Ajneya; Purohuta; Purushrta; Brahmagarbha; Vrihadgarbha; Dharmadhenu; Dhanagama; Jagaddhitaishi; Sugata; Kumara; Kushalagama; Hiranyavarna; Jyotishmana; Nanbhutarata; Dhvani; Araga; Nayandyaksha; Vishvamitra; Dhaneshvara; Brahmajyoti; Vasudhama; Mahajyotianuttama; Matamaha; Matarishva; Nabhasvana; Nagaharadhrika; Pulastya; Pulaha; Agastya; Jatukarnya; Parashara; Niravarananirvara; Vairanchya; Vishtarashrava; Atmbhu; Aniruddha; Atri; Jnanamurti; Mahayasha; Lokaviragranti; Vira; Chanda; Satyaparakrama; Vyalakapa; Mahakalpa; Kalpaviriksha; Kaladhara; Alankarishnu; Achala; Rochishnu; Vikramonnata; Ayuhsabdapati; Vegi; Plavana; Shikhisarathi; Asamsrishta; Atithi; Shatrupreamathi; Padapasana; Vasushrava; Pratapa; Havyvaha; Vishvabhajana; Japaya; Jaradishamana; Lohitatma; Tanunapata; Brihadashva; Nabhoyoni; Supratika; Tamisraha; Nidagha; Tapan; Megha; Svaksha; Parapuranjaya; Sukhanila; Sunishpanna; Surabhi; Shishiratmaka; Vasanta; Madhava; Grishma; Nabhasya; Vijavahana; Angira; Guru; Atreya; Vimala; Vishvavahana; Pavana; Sumati; Vidvata; Travidya; Naravahana; Manobuddhi; Ahankara; Kshetrajna; Kshetrapalaka; Jamadagni; Balanidhi; Vigala; Vishvagalava; Aghora; Anuttara; Yajna; Shreye; Nishshreyahpatha; Shaila; Gaganakundabha; Danavari; Arindama; Rajanijanaka; Charuvishalya; Lokakalpadhrika; Chaturveda; Chatrubhava; Chatura; Chaturapriya; Amlaya; Samamlaya; Tirthavedashivalaya; Vahurupa; Maharupa; Sarvarupa; Charachara; Nyayanirmayaka; Nyayi; Nyayagamya; Nirantara; Sahasramurddha; Devendra; Sarvashastraprabhanjana; Munda; Virupa; Vikranta; Dandi; Danta; Gunottama; Pingalaksha; Janadhyaaksha; Nilagriva; Niramaya; Sahasravahu; Sarvesha; Sharanya; Sarvalokadhrika; Padmasana; Paramjyoti; Parampara; Paramphala; Padmagarbha; Mahagarbha; Vishvagarbha; Vichakshana; Characharajna; Varada; Varesha; Mahabala; Devasuraguru; Deva; Devasuramahashraya; Devadideva; Devagni; Devagnisukhada; Prabhu; Devasureshvara; Divya; Devasuramaheshvara; Devadevamaya; Achintya; Devadevatmasambhava; Sadyoni; Asuravyaghra; Devasimha; Divakara; Vibudhagravara; Shreshtha; Sarvadevottamottama; Shivajnanarata; Shrimana; Shikhi-shriparvatapriya; Vajrahasta; Siddhakhadgi; Narasimhanipatana; Brahmachari; Lokachari; Dharmachari; Dhanadhupa; Nandi; Nandishvara; Ananta; Nagnavratadhara; Shuchi; Lingadhyaksha; Suradhyaaksha; Yogadhyaaksha; Yugavaha; Svadharma; Svargata; Svargakhara; Svaramayasvana; Vanadhyaaksha; Vijakarta; Dharmakrit; Dharmasambhava; Dambha; Alobha; Arthavit; Shambhu; Sarvahbutamaheshvara; Shmashananilaya; Tryksha; Setu; Apratimakriti; Lokottaras-phutaloka; Trymbaka; Nagabhushana; Andhakai; Makhaveshi; Vishnukandharapatana; Hinadosha; Akshayaguna; Dakshari; Pushadantabhit; Dhurjati; Khandaparashu; Sakala; Nishkala; Anagha; Akala; Sakaladhara; Pandurabha; Mrida; Nata; Purna; Purayita; Punya; Sukumara; Sulochana; Samageyapriya; Akrua; Punyakirti; Anaymaya; Manojava; Tirthakara; Jatila; Jiviteshvara; Jivitantakara; Nitya; Vasureta; Vasuprada; Sadgati; Satkriti; Siddhi; Saijati; Kalakantaka; Kaladhara; Mahakala; Bhuasatyapraryana; Lokalavanyakarta; Lokottarasukhalaya; Chandrasanjivana; Shasta; Lokaguda; Mahadhupa; Lokabandhu; Lokanatha; Lokanatha; Kritajna; Krittibhushana; Anapaya; Akshara; Kanta; Sarvashastrahadvara; Tejomaya; Dyutidhara; Lokagranti; Anu; Shuchismita; Prasannatma; Durjjeya; Duratikrama; Jyotirmaya; Jagannatha; Nirakra; Jaleshvara; Tumbavina; Mahakopa; Vishoka; Shokanashana; Trilokapa; Trilokesha; Sarvashuddhi; Adhokshaja; Avyaktalakshana; Deva; Vyaktavyakta; Vishampati; Varashila; Varaguna; Saramandhana; Maya; Brahma; Vishnu; Prajapala; Hamsa; Hamsagati; Vaya; Vedha; Vidhata; Dhata; Srashta; Harta; Chaturmukha; Kailasa-Shikharavasi; Sarvasasi; Sadagati; Hiranyagarbha; Druhina; Bhutapa; Bhupati; Sadyogi; Yogavit; Yogi; Varada; Brahmanapriya; Devapriya; Devanatha; Devajna; Devachintaka; Vishamaksha; Vishalaksha; Vrishada; Vrishavardhana; Nirmama; Niraahamkara; Nirmoha; Nirupadrava; Darpha; Darpada; Dripta; Sarvabhutaparivartaka; Sahasrajit; Sahasrarchi; Prabhava; Snigddhaprakritidakshina; Bhutabhavyabhavannatha; Bhutinashana; Artha; Anartha; Mahakosha; Parakaryaikapandita; Nishkantaka; Kritananda; Nirvyaja; Vyajamaradana; Sattavavana; Sattvika; Satyakirti; Snehakritagama; Akampita; Gunagrahi; Naikatma; Naikakarmakrit; Suprita; Sumukha; Suksha; Sukara; Dakshinaila; Nandiskandhadhara; Dhurya; Prakata; Pritivardhana; Aparajita; Sarvasattva; Govinda; Adhrita; Sattvavahana; Svadhrita; Siddha; Putamurti; Yashodhana; Varahabhiringadhrika; Bhringi; Balavana; Ekanayaka; Shrutiprakasha; Shrutimana; Ekabandhu; Anekakrit; Shrivatsalashivarambha; Shantabhadra; Sama; Yasha; Bhushaya; Bhushana; Bhuti; Bhutakrit; Bhutabhavana; Akampa; Bhaktikaya; Kalaha; Nilalohita; Satyavrata; Mahatyagi; Nityashantiparayana; Pararthavritti; Vivikshu; Visharada; Shubhada; Shubhakarta; Shubhanama; Shubha; Anarthita; Aguna; Sakshi; Akarta

1008 Names of Lord Shiva



MAHESHWARA, as per the holy Vedas, is a form of Lord Shiva.

He is the one who rules over all beings in the Universe.

He commands the Sunrise, the Sunset and the Seasons.

He confers holy virtues Et resides everywhere.



Dedicated to the loving memory of
SHRI MAHESHWAR NATHRAHEJA
 11/01/1918 - 02/02/1976

MAHESHWARA, the Divine Power shaping a heavenly structure standing tall
 in the middle of the enchanting beauty of hills, the feel of pure breeze and
 the vast stretches of blue skies.

MAHESHWARA, designed by the virtues of Rudra is a home for the nature lover, the
 adventure enthusiast, the spiritually evolved, God's own Child, YOU



MAHESHWARA
 SPIRITUALITY. VALUES. ENTERTAINMENT *and* FORESTED LANDSCAPE

THE TALLEST IN HARYANA



REVANTA

THE TALLEST IN DELHI



NAVIN MINAR

THE TALLEST ON A NATIONAL HIGHWAY



OMA

FROM
THE HOUSE OF



India's Best Developer*

Best Developer Worldwide**

India's Most Awarded Developer ***

Impeccable Quality & Delivery Record
for over 25 years

OUR ICONIC PROJECTS

*Euromoney UK, 2011, 2012, 2013

**OPP, UK, 2012,

***More than 100 awards



MUMBAI INTERNATIONAL AIRPORT - CRAFTED BY L&T



BURJ KHALIFA - WORLD'S TALLEST BUILDING - CRAFTED BY ARABTEC

INFRASTRUCTURE BY



Larsen and Toubro

CONSTRUCTION BY



OUR CONTRACTORS

*Developer reserves the right to replace contractors depending on work progress for betterment of project.



PART OF
RAHEJA ARANYA,
INDIA'S MODEL
SMART GREEN CITY

Spread over 165 acres, Aranya City is probably the only city in Delhi-NCR offering views of Aravallis on all sides, Double layer Concrete Roads, Solar LED Lighting for the entire city, Schools, Dispensaries, Shopping Centre, Hotels, Community Centre, Old Age Homes, Shopping Complexes as well as Nature friendly green features like Water Harvesting etc. Surrounded by nature, yet close to civilization, Aranya is truly a destination. And Maheshwara gives you yet another reason to be here.

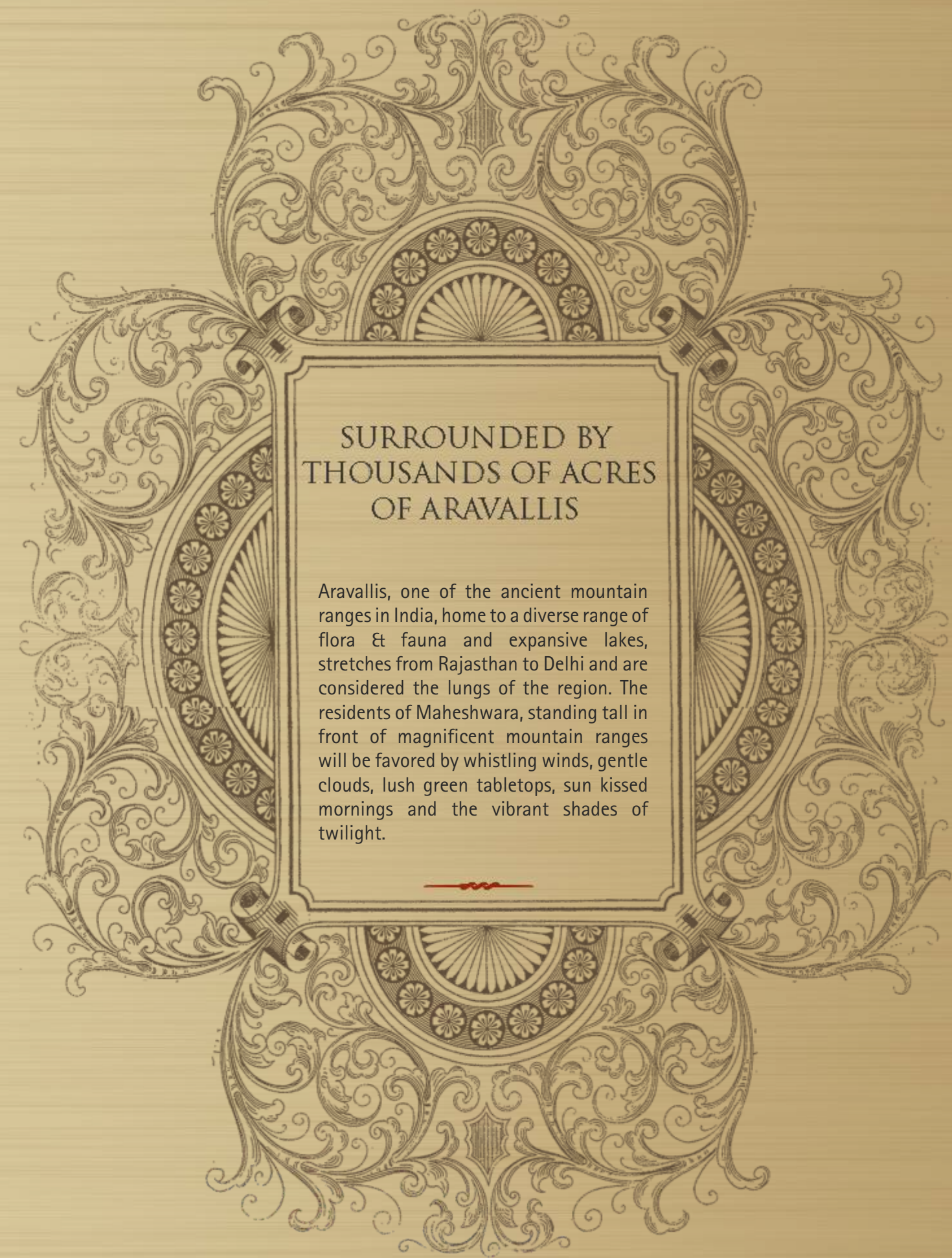

SURROUNDED BY
THOUSANDS OF ACRES
OF ARAVALLIS

Aravallis, one of the ancient mountain ranges in India, home to a diverse range of flora & fauna and expansive lakes, stretches from Rajasthan to Delhi and are considered the lungs of the region. The residents of Maheshwara, standing tall in front of magnificent mountain ranges will be favored by whistling winds, gentle clouds, lush green tabletops, sun kissed mornings and the vibrant shades of twilight.



MAHESHWARA

SPIRITUALITY, VALUES, ENTERTAINMENT *and* FORESTED LANDSCAPE



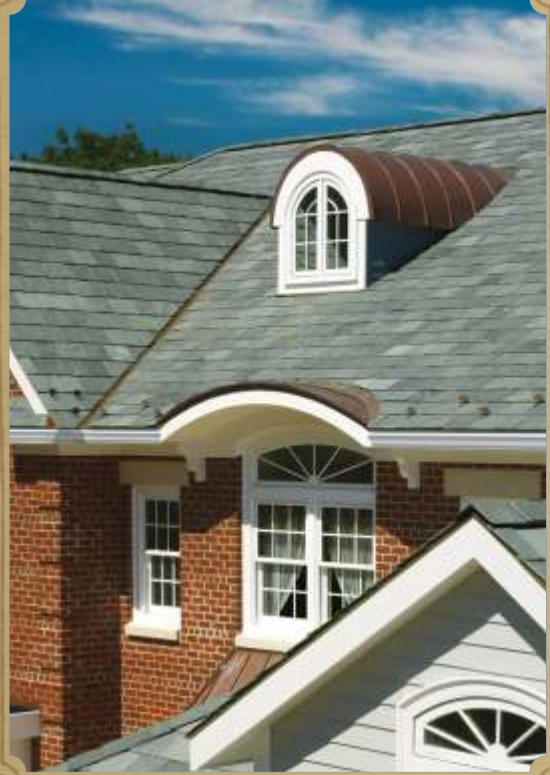

A SKETCH FROM BRITISH ARCHITECTURE

Inspired by the legacy of a rich colonial era represented by Manicured Gardens, Geometrical Landscape, Symmetrical Arches, Sloping Roofs, Glorious Pediments, Pilastered Walls & Colonnaded Porches. Maheshwara's architecture is a tribute to the glorious British Era.

ENGRAVED WITH SPIRITUALITY:



Maheshwara is built on the values of spiritual living. Religion and divine values are part of every family, values that are built in and set to work by the elderly people in the family. Maheshwara, an important part of Aranya city is inspired by the Religion of Humanity, giving divine values to the city and to the community, features like Meditation Areas, Praying Areas & Yoga Classes help in rediscovering your inner self. The fresh mountain air helps too!

INDIA'S FIRST ADVENTURE CITY : ARANYA



All Terrain Vehicle



Go Karting



Zorbing

For the first time in India, we have introduced adventure activities on a scale never before experienced under one roof :

- Go Karting
- ATV - All Terrain Vehicle Obstacle Course
- Ziplining
- Zorbing
- Adventure Camp
- Hot Air Ballooning and Paramotoring & many others



ARANYA FACILITIES*

While India gears up to establish the first 100 smart cities, we have geared up too by committing ourselves to the grand vision of a modern India.

- Open Air Amphitheater, Food Plaza, performances at the Shopping Centre overlooking the mountains
- Dispensary, Schools
- Regular organic farming sessions organized by our landscape team
- Regular Yoga & Meditation classes organized by experts at the Yoga & Meditation Centre
- Central City monitoring CCTV Cameras
- 24/7 gated security
- Regular beats, patrolling & traffic assistance
- Round-the-clock safety and security measures
- Security outposts at crucial points
- Latest fire-safety measures
- Located close to schools, universities and multi speciality hospital
- In close vicinity of shopping arcade and commercial setups
- In close vicinity of natural sulphur springs, a great picnic spot

The future is on our door and we are here to embrace it . We are committed to providing back to Mother Nature whatever we took from her, by providing features like...

- Planned Rooftop Solar Power Generation for entire city
- Rain Water Harvesting
- Solar Street Lighting
- Recycled Water for Flushing & Landscape
- Zero Discharge
- Over 10000 trees and maximum green area left for landscape
- Integrated City Management System
- Electric Golf Carts for internal transportation
- Planned shuttle service till Rajiv Chowk



MAHESHWARA FACILITIES*



- A club house with swimming pool, gymnasium, spa and sauna
- Badminton and tennis courts in the premises
- Planned park inside the premises for encouraging yoga and meditation
- Activity center with card rooms, hobby rooms and various other games
- Community hall for organizing Bhajan, pooja and other religious and social functions
- Fully operational central dining hall
- Benches in corridors, staircase landings and lawns
- Children's play area with variety of rides
- Facilities of pharmacy, provision store and ATM Center in the premises



AN ABODE FOR GOLDEN AGERS

Aman Limited Edition Units** at Maheshwara are designed and developed based on an idea of delivering pleasurable living to golden agers. These units are carefully designed taking into consideration the generation of the inhabitants providing an address for some of those dignified citizens. The building offers units with step free entrance and large open spaces both internally and externally.

These units are especially designed to match the lifestyle of golden agers of the society. A happy ending of work life calls for a more joyous and exciting life after retirement. The time to spend those golden years independently in harmony needs a setup that promises respite, respect, responsibility and resources at one juncture.

FEATURES TO MAKE YOU FEEL SAFE, FEEL STEERED AND FEEL SUPPORTED

- Anti skid tiles across the unit
- Non slippery and guarded railings in the balconies for better grip
- Easy to operate Bathroom fittings for people with arthritis and toilet guard to prevent unhygienic accidents
- Single entry premises under CCTV surveillance with intercom facility for better safety
- Red markings on staircase for better identification of access way
- 24x7 emergency medical service with nurse and ambulance on site*
- Facility of a resident doctor for better assistance in emergency *
- 24x7 response system in each unit with alarm buttons*
- On site concierge service for better maintenance and support*



FLOOR PLANS



TOWER B,C,D,F,G
TYPICAL FLOOR PLAN
2 BHK (TYPE 1)



TOWER B,C,J,D,F,G
TYPICAL FLOOR PLAN
2 BHK (TYPE 3)



*Super area & Carpet area may have little variation from the area depicted in the brochure at the time of final audit after OC is received.

*Super area & Carpet area may have little variation from the area depicted in the brochure at the time of final audit after OC is received.

TOWER - B,C,J,D,F,G
TYPICAL FLOOR PLAN
2 BHK(TYPE 2)



SALEABLE AREA: 1199 SQ.FT.
CARPET AREA: 865.64 SQ.FT.



TOWER A & K
TYPICAL FLOOR PLAN
3 BHK (TYPE 3)



SALEABLE AREA: 1706 SQ.FT.
CARPET AREA: 1251.75 SQ.FT.



TOWER - E
13TH FLOOR PLAN
PENTHOUSE (TYPE 2)

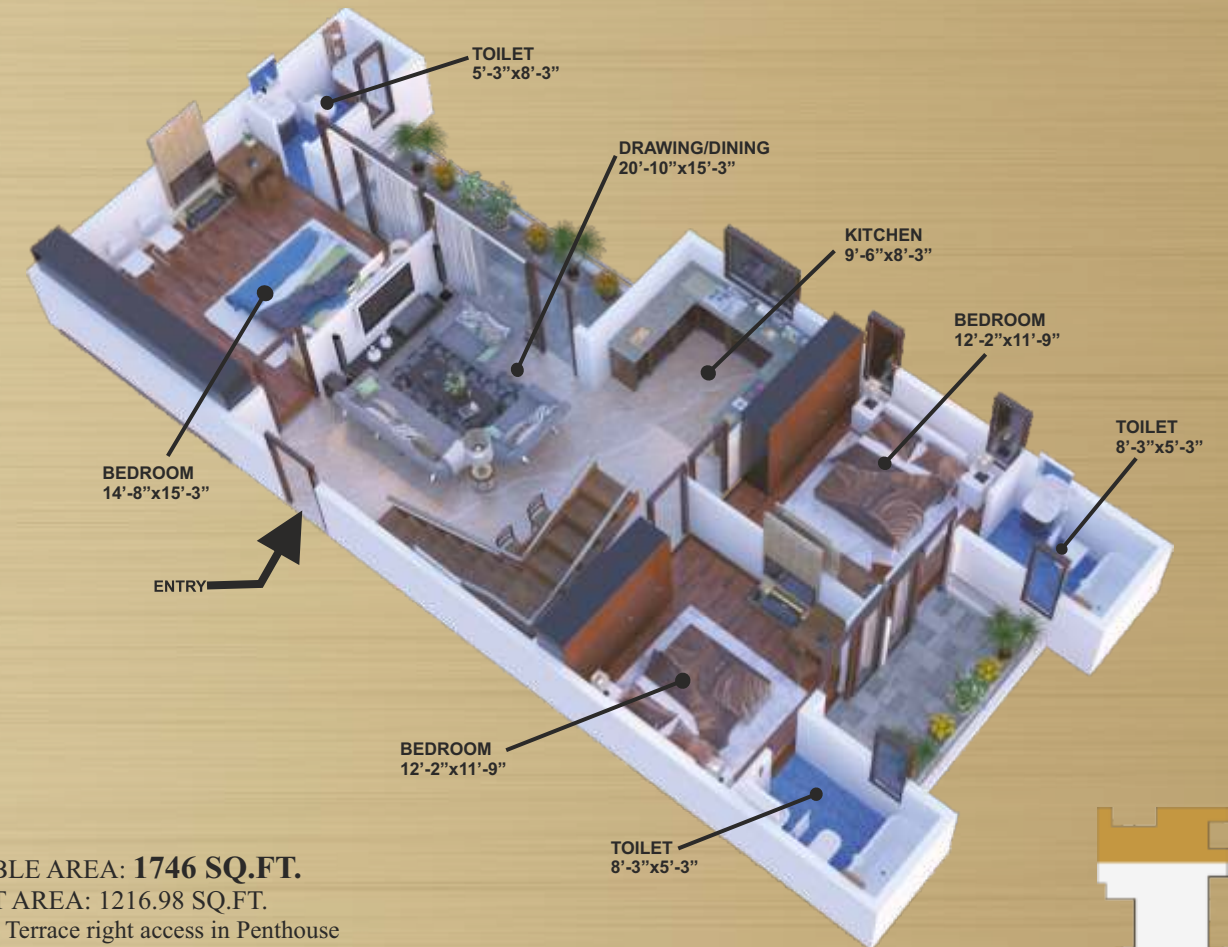

SALEABLE AREA: 1746 SQ.FT.
CARPET AREA: 1216.98 SQ.FT.
User gets Terrace right access in Penthouse



TOWER A & K
TYPICAL FLOOR PLAN
3 BHK (TYPE 4)



SALEABLE AREA: 1630 SQ.FT.
CARPET AREA: 1191.04 SQ.FT.



*Super area & Carpet area may have little variation from the area depicted in the brochure at the time of final audit after OC is received.

*Super area & Carpet area may have little variation from the area depicted in the brochure at the time of final audit after OC is received.

TOWER-E
TYPICAL FLOOR PLAN
3BHK (TYPE 7)

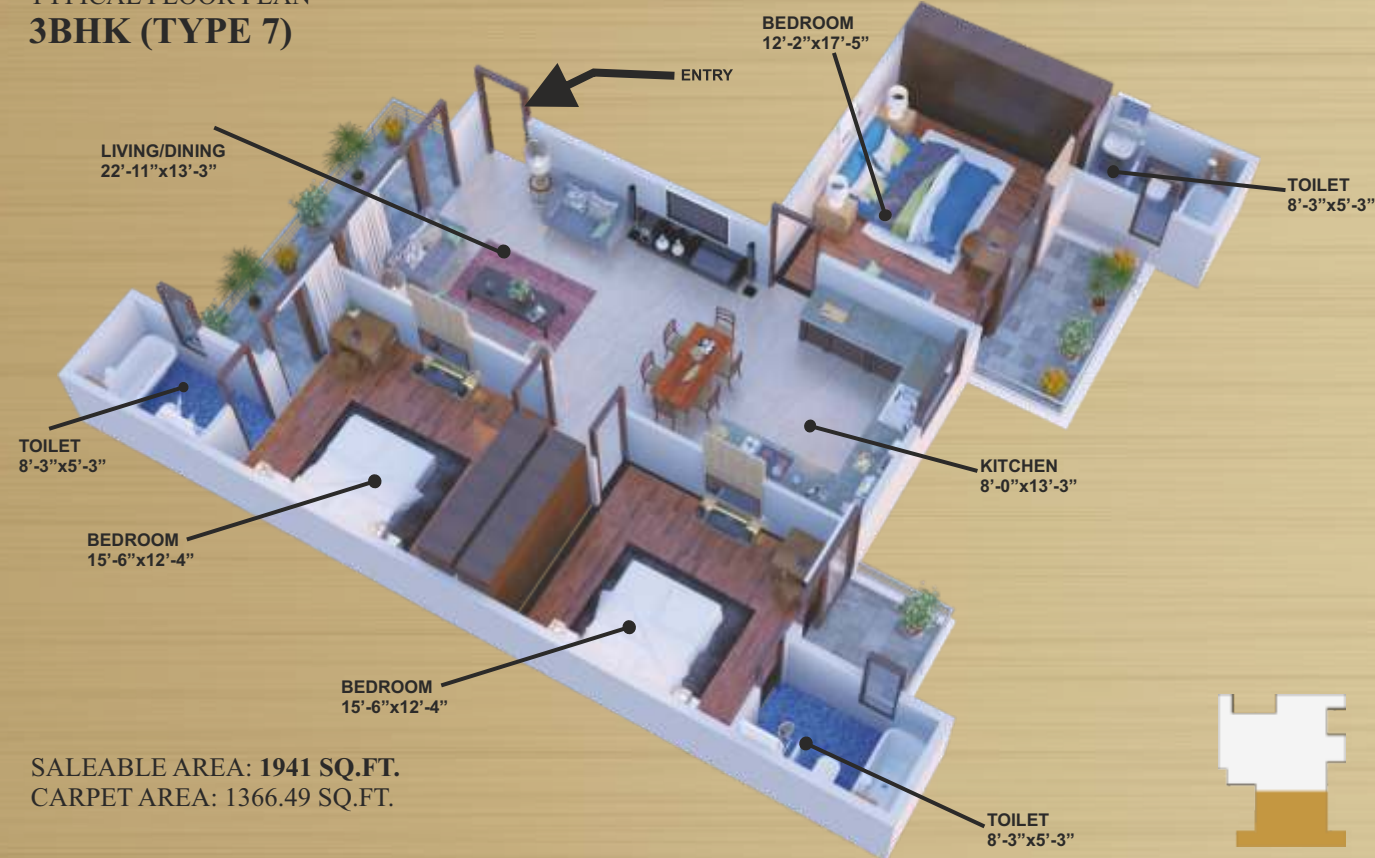

SALEABLE AREA: 1941 SQ.FT.
CARPET AREA: 1366.49 SQ.FT.

TOWER A & K
GROUND FLOOR PLAN
2 BHK



SALEABLE AREA: (TYPE 7) 1967 SQ.FT.
(TYPE 8) 1539 SQ.FT.
CARPET AREA: 965.64 SQ.FT.

TOWER - B, C, J, D, F, G
GROUND FLOOR PLAN
3 BHK (TYPE 5)

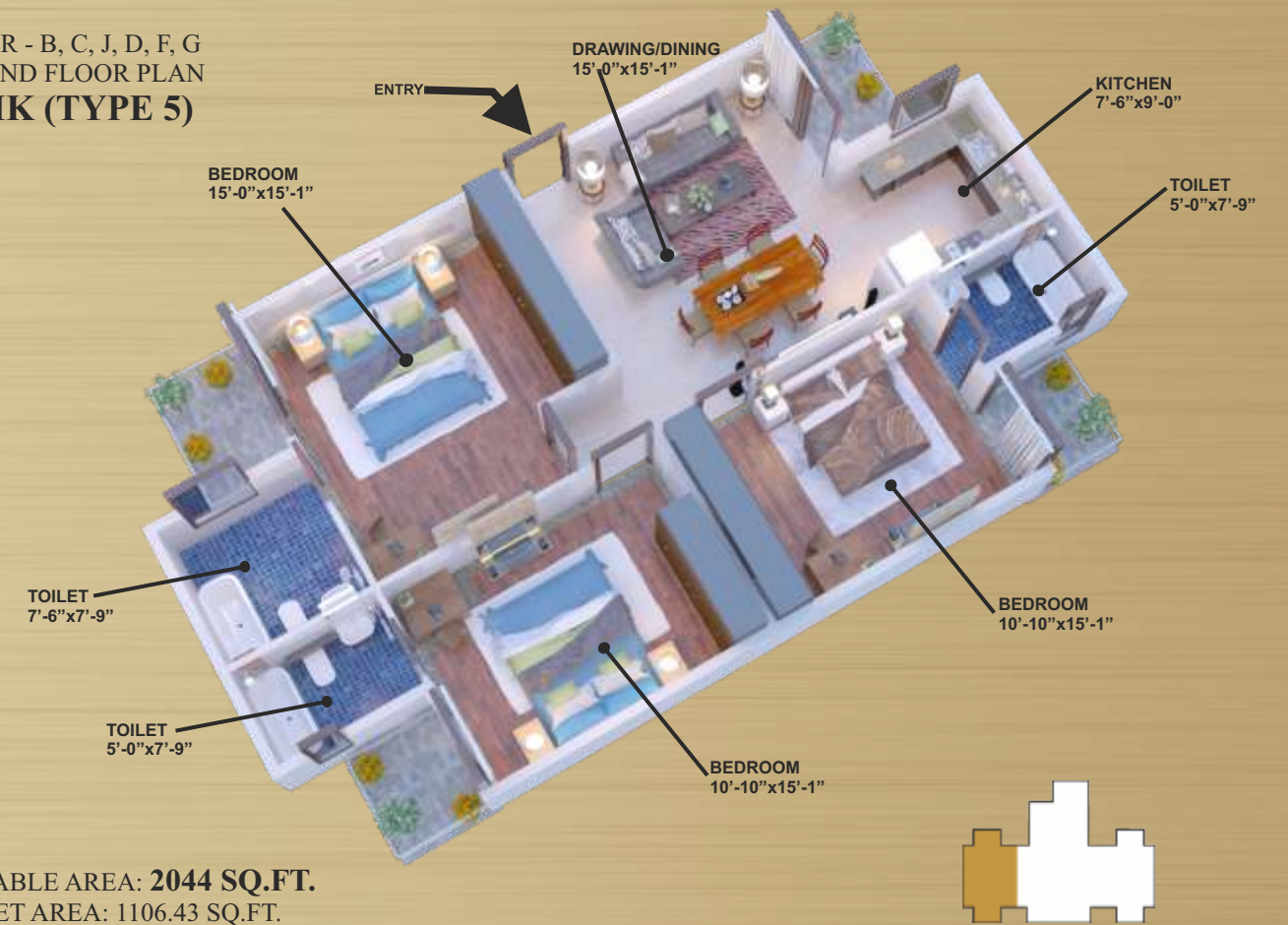

SALEABLE AREA: 2044 SQ.FT.
CARPET AREA: 1106.43 SQ.FT.

TOWER-E
TYPICAL FLOOR PLAN
3 BHK (TYPE 6)



SALEABLE AREA: 2224 SQ.FT.
CARPET AREA: 1216.98 SQ.FT.

*Super area & Carpet area may have little variation from the area depicted in the brochure at the time of final audit after OC is received.

*Super area & Carpet area may have little variation from the area depicted in the brochure at the time of final audit after OC is received.

TOWER - E
13TH FLOOR PLAN
PENTHOUSE (TYPE 3)

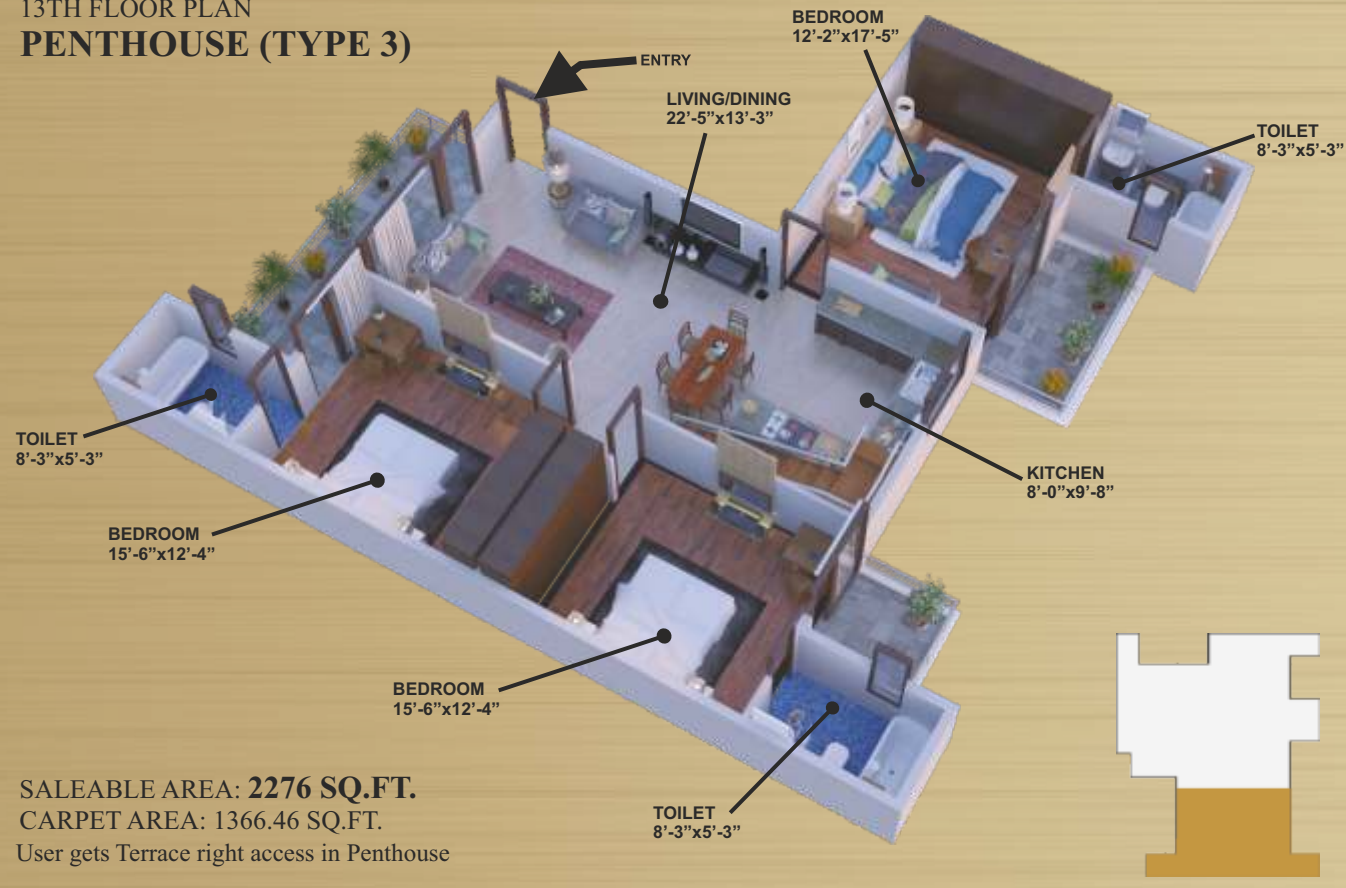

TOWER B,C,J
LOWER PENTHOUSE (TYPE 1)



TOWER - D
13TH FLOOR PLAN
PENTHOUSE (TYPE 4)



TOWER B,C,J
UPPER PENTHOUSE (TYPE 1)



IMPECCABLE QUALITY AND DELIVERY RECORD
SINCE OVER 25 YEARS

RAHEJA™
OUR PROJECTS



RAHEJA ATLANTIS (Built)



ATLANTIS VILLAS (Built)



RAHEJA PINE GARDEN (Built)



RAHEJA VEDAANTA (Built)



RAHEJA VEDAANTA FLOORS (Built)



RAHEJA VEDAS (Built)



RAHEJA ATHARVA (Built)



RAHEJA SHILAS (Built)



RAHEJA SHILAS FLOORS (Built)



RAHEJA NAVODAYA (Built)



RAHEJA SAMPADA (Built)



RAHEJA REVANTA (Under Construction)



RAHEJA OMA (Under Construction)



NAVIN MINAR (Upcoming)



RAHEJA VANYA (Upcoming)



RAHEJA AYANA (Under Construction)



RAHEJA ARANYA TOWNSHIP (1st Phase Ready for Delivery)



RAHEJA ARABELLA (Under Construction)



RAHEJA ARANYA FLOORS (Under Construction)



RAHEJA TRINITY (Under Construction)



KRISHNA HOUSING (Under Construction)



RAHEJA KRISHNA COMMERCIAL (Upcoming)



RAHEJA SQUARE (Built)



RAHEJA TRADE TOWER (Built)



RAHEJA MALL (Built)



HIGHWAY ARCADE (Ready for Delivery)



RAHEJA EDGE (Upcoming)

RAHEJA™ honors



Raheja Developers Limited are accredited with over 100 awards on national as well as global podium from some of the most credible agencies. Some of them are :

- CNBC Awaaz Crisil Real Estate Award
- Cityscape Asia Awards
- Asia Pacific Bloomberg Google Property Awards
- OPP(London) Excellence Awards
- Zee Business RICS Awards
- Golden Peacock Award for innovation management
- EUROMONEY Award for Best Developer in India for three consecutive years 2011, 2012 and 2013 and many more...

TRANSPARENCY@RAHEJA

At Raheja, we pride ourselves in always implementing new and innovative processes to keep you updated about your property. Join us on Facebook, YouTube or our continuously updated website to watch the latest construction update videos, virtual tours, new product offerings and newsfeeds from anywhere in the world or while on the move. We also take pride in being one of the few real estate companies to run on specially developed ERP software which provides accountability and transparency in process.

Every Raheja customer gets a unique username and password to his account. What it means for you is that you can always be aware of the present construction status of your property and your account statements. Demand letters are sent along with latest photographs and only after uploading the latest construction update videos on Youtube which is accessible at the touch of a button while you relax at home.

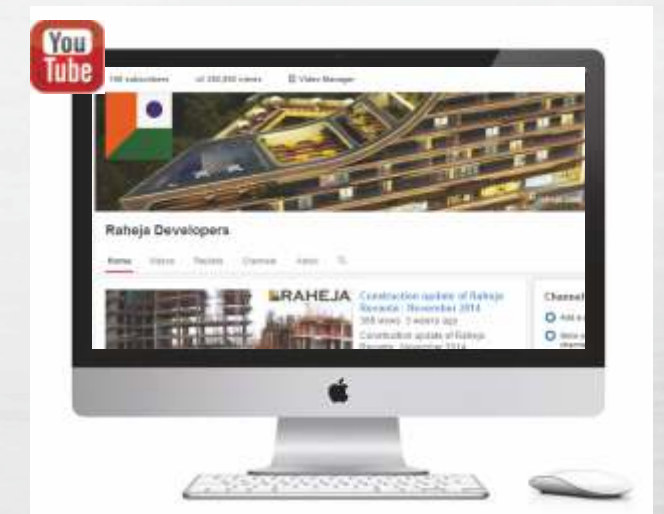



ENVIRONMENTAL RESPONSIBILITY

Under the guidance of Mr. Navin M. Raheja, a keen naturalist and environmentalist, Raheja Developers abides with strict norms and regulations in their working which makes them develop commercial and residential structures that leaves least environmental footprints. The ecological mechanism used by Raheja's in construction include:

- Water harvesting and reuse of Sewage water for landscaping
- Use of double glazed, thermally insulated and tinted glass for Windows
- Use of photo voltaic cells to generate solar energy
- Use of non toxic biodegradable materials in construction activity
- Use of energy conserving light fittings like CFLs across India.



Raheja Productions, a Raheja subsidiary is a popular producer of films and documentaries based on varied subjects pertaining to today's general issues. The company is also active in developing projects for corporates, NGOs and Government organizations across India.

Played successful seasons on:



Mr. Raheja with Tom Alter, Anchor of "Jungle ki Kahaniyan" by Raheja Productions



A still from the show "Jungle" by Raheja Productions

Wildlife Awards

- Ramnath Goenka Excellence in Journalism Awards bestowed on Raheja Productions a subsidiary of Raheja Developers that works towards wild life conservation and Environment protection in the category "Environment Reporting"
- Justice BP Banarjee Green Man Award to Mr Navin M Raheja, Producer of "The Rise and Fall of Ustad" at 1st Kolkata International Wildlife & Environment Film Festival 2015
- "Desham Save the Tiger Award " for our Film "The Rise and Fall of Ustad " at 1st Kolkata International Wildlife & Environment Film Festival 2015
- 2rd Prize in 10th Kirloskar Vasundhara International Film Festival for our film "The Rise and Fall of Ustad"
- 3rd Prize in 9th Kirloskar Vasundhara International Film Festival for our film " on losing ground"

112 episodes of our series Wilderness Days have been telecasted on DD National and DD India is currently the longest running series on Indian Wildlife. The series has extensively covered wildlife and environmental issues in India and was particularly popular among wildlife enthusiasts and the youth. Raheja Productions' documentaries have been aired on NGC also.

CORPORATE SOCIAL RESPONSIBILITY

- House of Raheja provide their onsite workforce with all the necessary safety equipment like helmets, safety nets and shoes with resistant soles.
- They provide free wholesome meals once in a week to all the workers.
- Workers on site are trained to improve their efficiency in order to progress and live a more responsible life.
- The company sets up day care centers at every construction site for the children of their onsite workers to provide them with primary education.
- The company provides 3 meals a day, pair of clean clothes and books to read to every child of the workers, a step ahead in the direction of making them a much more responsible citizens of tomorrow.
- Raheja's run Gayatri Sansthan an NGO as a social initiative to educate children from unprivileged class of the society. The institute imparts primary education that includes learning of subjects English, Maths, Hindi and computers. They even train children with yoga and yagna thereby adding virtues to their lives.



Raheja's run Gayatri Sansthan an NGO as a social initiative to educate children from unprivileged class of the society.

CSR AWARDS

- Awarded Redevelopment Project of the Year for Kathputli Colony at Franchise India 7th Annual Estate Award
- Awarded "Redevelopment Project of the Year" for Kathputli Colony, Delhi at 6th Realty Plus Excellence Awards 2014
- Awarded in the category of Corporate Social Responsibility at the Cityscape Awards Real Estate Asia 2010
- Awarded in the category of Social Development and Impact at CIDC Vishwakarma Award 2015
- Awarded "Best CSR Initiative" by NAREDCO's at 12th Convention on "Housing for All - 2022"
- "Best CSR Initiative of the Year" at Assocham Excellence Awards 2014
- Awarded Silver Category at "3rd Annual Greentech CSR Award 2014".
- Mr Navin Raheja Awarded "Social Entrepreneur of the Year" at Entrepreneur India 2014





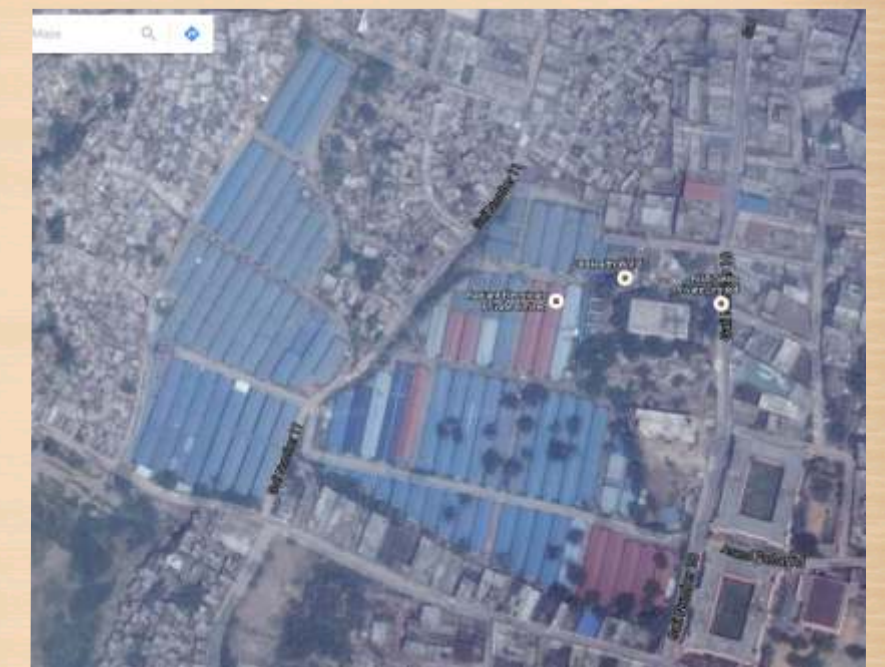





In-Situ Slum Rehabilitation Project

Have you ever wondered this colourful spot captured on google image right in the centre of Delhi is about to re write "History of poverty and deprivation in India". Raheja Developers Limited has been awarded the first of it's kind In-Situ Slum Rehabilitation Scheme at Kathputli Colony, spread over 5.22 hectares near Shadipur Depot, by the Delhi Development Authority. This world class facility has been created by Raheja Developers as Transit camp for approx 15000 slum dwellers at Anand Parvat in Central Delhi with complete facilities of toilets, S.T.P, RO drinking water supply, greenescapes, schools etc - a city in itself.



First of it's kind In-Situ Slum Rehabilitation Scheme at Kathputli Colony

Maheshwara is developed under license no 25 of 2012 dated 29.03.12 and HRERAC Certificate No. 20/06-07-2017 for an area measuring 9.23 acres. Name of the colonizer: M/s Raheja Developers Ltd. No. & Date of the approved Building Plans: ZP-869-A/AD(RA)/2016/2034 dated 29/01/2016, which is granted for Residential Group Housing Use. Layout plans and Building plans are approved through various memos issued from time to time developed by Raheja Developers Ltd. (Company). The Company reserves its right to make changes as per the prevailing Government norms. All approvals can be checked at the registered/corporate office of the Company. The Company expressly disclaims any express or implied warranty of accuracy and assumes no liability for any error and/or omission of any information mentioned herein. Images shown in the brochure are pictorial conceptualization and representation only and it is an attempt to replicate the exact product; however, the actual may differ. Also, this brochure shall not constitute any legal offer. All the site plans, areas including super area or saleable area or carpet area, dimensions, specifications, perspective view, floor plans, facilities and amenities are tentative in nature and the information and contents provided herein are subject to change as per Company's discretion without any prior notice. The Company shall not be responsible for construction of infrastructural facilities and the Company's responsibility is only limited towards depositing the EDC to the Respective Department for development of such infrastructural facilities. Terms & conditions apply.

<p>RAHEJA</p> <p>OUR ASSOCIATES</p>	 <p>Arabtec Construction, LLC (UAE)</p> <p>The construction company that built Burj Khalifa. The tallest building in the world. Building Raheja Revana and shall be building Raheja Ayana</p>	 <p>PERI SKYDECK is German shuttering & scaffolding system which decreases the slab cycle from 20-25 days to 5-6 days, thereby increasing speed of construction and dramatically improving the quality. Being used at Raheja Revanta.</p>	 <p>Larsen and Toubro</p> <p>India's leading construction company Building Raheja Aranya, India's first Smart Green City.</p>
<p>TATA HOUSING</p> <p>Joint venture partner in Raisina & Arabella projects</p>	 <p>Meinhardt, Singapore, Designers of Dubai Mall, Marina Bay Sail & Financial Centre. MEP consultants for Raheja's Oma, Dharuhera.</p>	<p>GRAND CINEMAS</p> <p>The largest multiplex chain in UAE. Operating 4 Screen Multiplex at Raheja Mall, Gurgaon.</p>	 <p>20 years old German Facade consultancy company operating in more than 15 countries globally. Designing Facade for Raheja Revanta.</p>
 <p>Thornton Tomasetti of USA Structural Engineers for 1 KM tall Kingdom Tower, Petronas Towers, Taipei 101 etc. Structural consultant for Raheja Revanta.</p>	 <p>Callison, an international architecture firm based in Seattle, Washington. \$ Awarded No. 1 in Retail Design consistently since 2003 by World Architecture. Designed Navin Minar, New Delhi.</p>	 <p>India's leading construction company Built Raheja Atharva & TATA Raheja Raisina</p>	 <p>One of the 5 largest International architectural firms. Designed Raheja Vanya Group Housing, Gurgaon</p>
 <p>Is an Australian company which is providing Comprehensive Facility Management Solutions for Raheja Projects.</p>	<p>VERSACE CERAMIC</p> <p>World's No. 1 luxury company. Supplying Building materials for Raheja Revanta Royalty, Limited Edition Apartments.</p>	 <p>Internationally acclaimed Lessard Design, USA Architects of Trump Parc & Trump Plaza. Designed Raheja Oma, Dharuhera.</p>	<p>GINGER</p> <p>Roots Corporation Ltd. (A TATA Group Company)</p> <p>Part of India's largest Hotel chain, the TATA Group. Operating a 100 room Hotel at Raheja Square.</p>

We believe in working with global experts so as to offer the best to our esteemed customers. Some of these names are also partnering us in grooming Maheshwara to be the finest valuable luxury homes in India.

